

**Brise Soleil Orientables / Madera**  
*Brise-Soleil Orientables / Bois*  
Movable Solar Shading Louvers / Timber

**brise soleil**

**madera** | *bois* | *timber*

**lama orientable gran formato** | *lame orientable grand format* | *large format movable blade*



brise soleil

madera | *bois* | *timber*

lama orientable gran formato | *lame orientable grand format* | large format movable blade



**brise soleil**

madera | bois | timber

**lama orientable gran formato** | *lame orientable grand format* | large format movable blade

lamas | lames | blades

WR

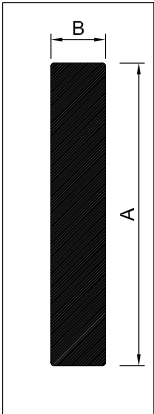

WA

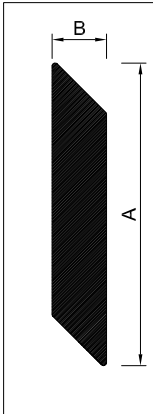

	A (mm)	B (mm)
WR.200	200	36
WR.250	250	36
WR.300	300	42
WR.350	350	48
WR.400	400	48
WA.200	200	36
WA.250	250	36
WA.300	300	42
WA.350	350	48
WA.400	400	48

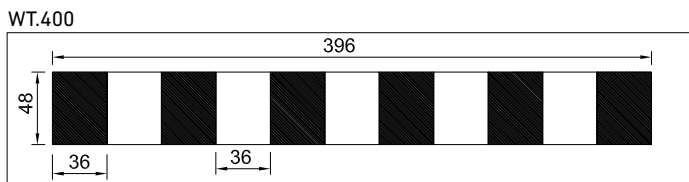
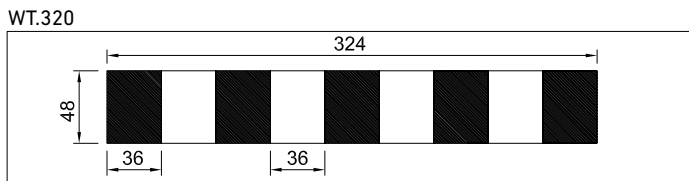
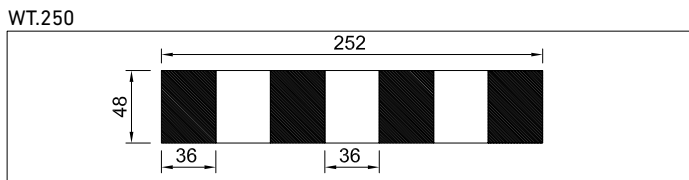

**montantes** | montants | mullions

**arrastre** | barre de manouvre | drive road

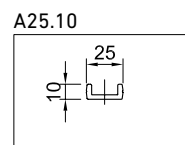
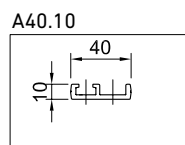
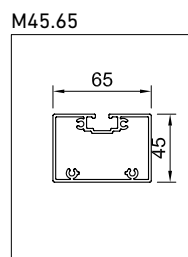
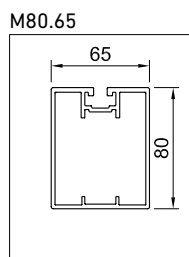

# brise soleil

madera | bois | timber

lama orientable gran formato | lame orientable grand format | large format movable blade

ejes | axes | axes

EFJ

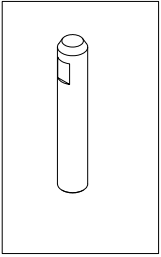

rótula | rotule | kneecap

KRT

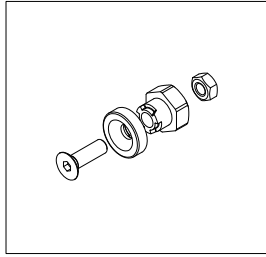

testeras | embouts | endplates - ALU 4mm

T.WA.40

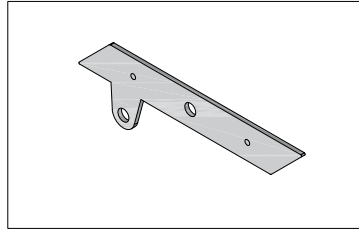

T.WA.20

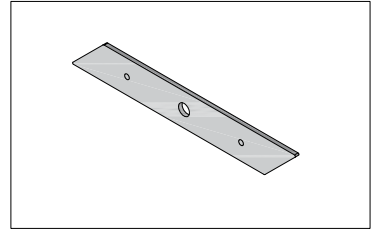

Anilla eje 8mm & 12mm / circlip 8mm & 12mm

A12

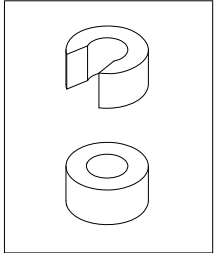

A08

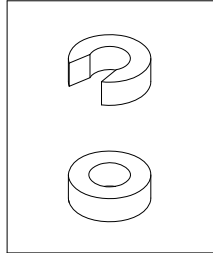

T.WR.40 / T.WT.40

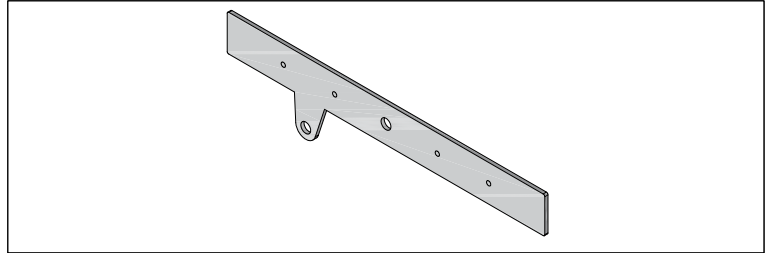

casquillo pivotación | canon épaulé | bearing support

CPT

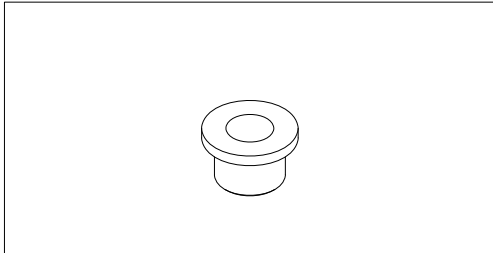

T.WR.20 / T.WT.20

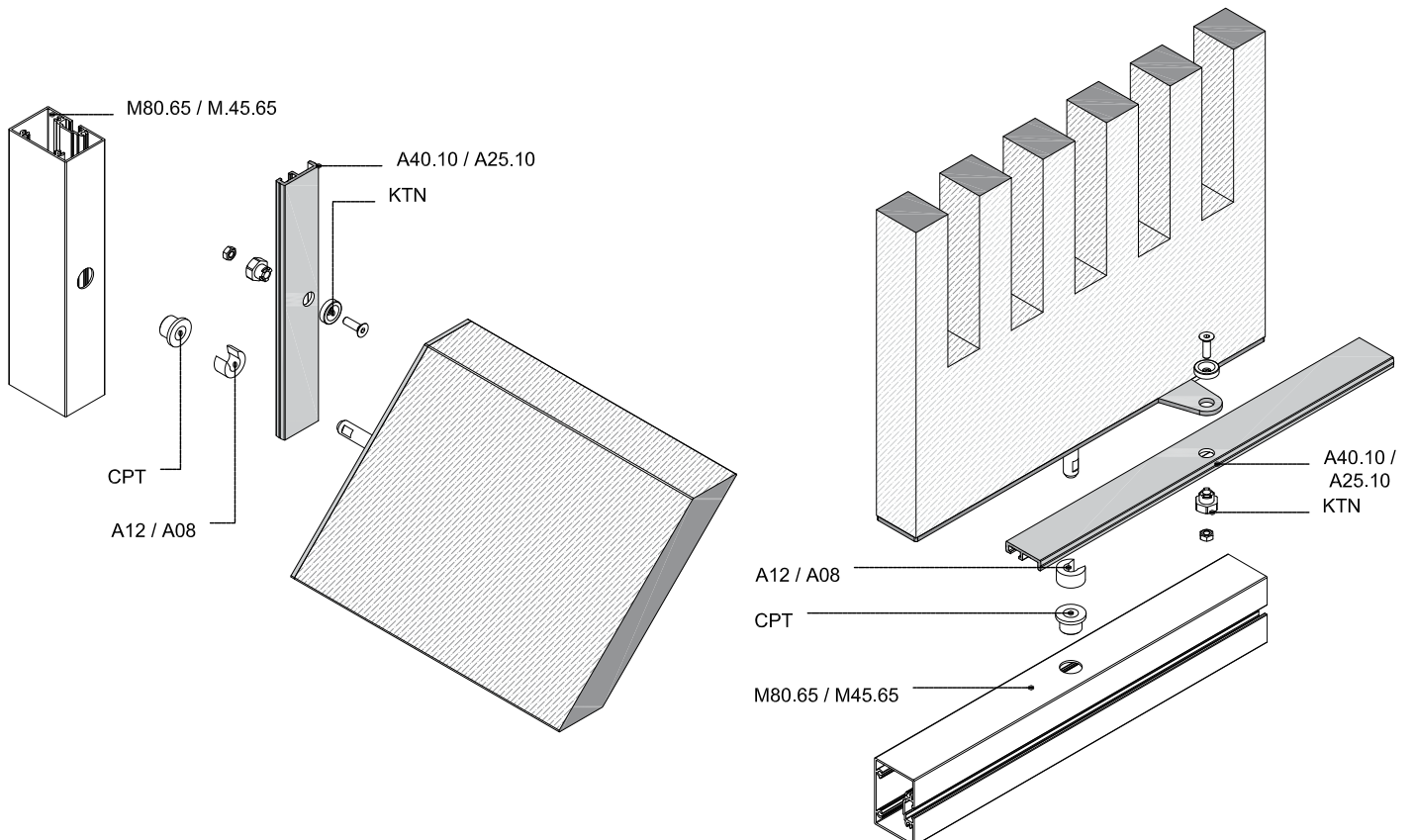
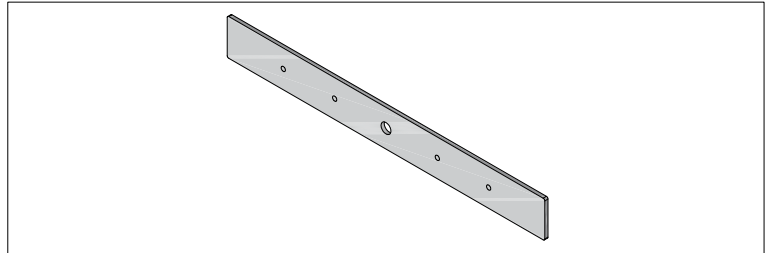

# brise soleil

madera | bois | timber

lama orientable gran formato | lame orientable grand format | large format movable blade

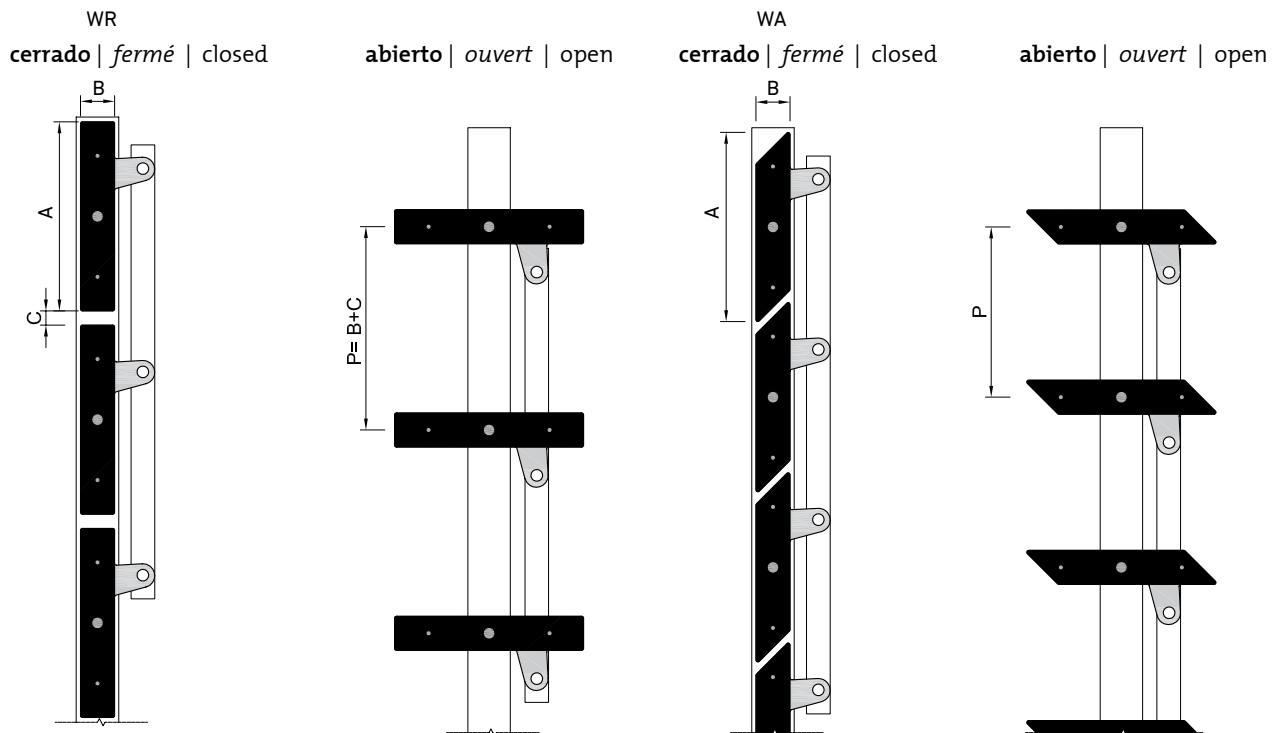

modelo modèle model	cotas principales dimensions principales main dimensions				madera   bois   timber		
	A (mm)	B (mm)	C Min (mm)	P Min (mm)	maciza massif solid	unión dentada abouté finger joint	laminada lamelle-collé glued laminated
WR.200	200	36	15	B+C	✓	●	●
WR.250	250	36	15	B+C	✓	●	●
WR.300	300	42	15	B+C		●	✓
WR.350	350	48	15	B+C		●	✓
WR.400	400	48	15	B+C		●	✓
WA.200	200	36		175	✓	●	●
WA.250	250	36		225	✓	●	●
WA.300	300	42		270		●	✓
WA.350	350	48		315		●	✓
WR.400	400	48		370		●	✓
WT.250	252	48	20	B+C	✓	●	
WT.320	324	48	20	B+C	✓	●	
WT.400	396	48	20	B+C	✓	●	

(\*) Medidas indicativas. Variable según especie | mesures indicatives. Variables selon les espèces | indicative measures. Variable according to species

● dependiendo del largo | en fonction de la longueur | depending on the length

● según la especie | selon les espèces | according to species

✋ manual | manuelle | manually

⚙️ mecánico | mécanique | mechanical

⚡ motor | moteur | motor

# brise soleil

madera | bois | timber

lama orientable gran formato | lame orientable grand format | large format movable blade

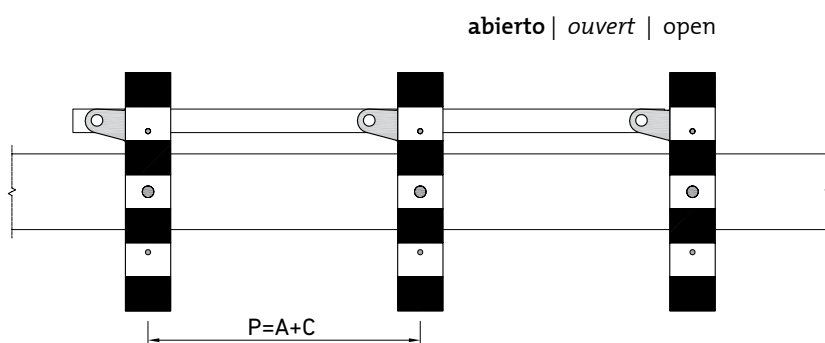
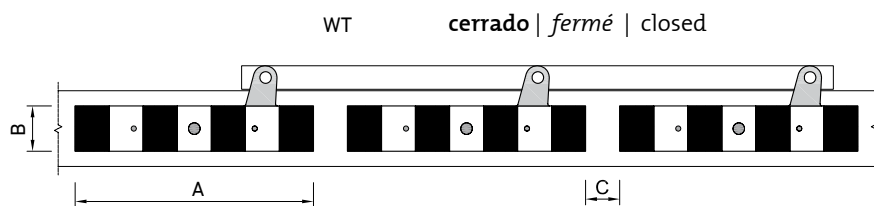

posición lama position lame blade position		largo máximo lama (*) longueur max lame (*) max length blade (*)		accionamiento commande operation
H	V	H	V	
✓	✓	1800	2500	🧤 ⚡
✓	✓	1800	2500	🧤 ⚡
✓	✓	2000	3000	🧤 ⚡
✓	✓	2000	3000	🧤 ⚡
✓	✓	2000	3000	🧤 ⚡
✓	✓	1800	2500	🧤 ⚡
✓	✓	1800	2500	🧤 ⚡
✓	✓	2000	3000	🧤 ⚡
✓	✓	2000	3000	🧤 ⚡
	✓		3000	🧤 ⚡
	✓		3000	🧤 ⚡
	✓		3000	🧤 ⚡









centro de investigación | *centre de recherche* | research center  
WT.400  
WD Arquitectos  
Madrid